

ALL-ROUND FLASHING LIGHT PMF 2015-M



Extremely bright due to 14 joules total flash energy of the impulse group and light bundling with fessel lens, low power consumption (energy-saving).

- The function of the flashing light is monitored internally via an optical sensor and evaluation circuitry.
- Both sub-systems (flashing light and monitoring unit) have separate operating voltage connections.
- The light is extremely failure-tolerant and carries type approval from the Swiss Ministry of Transport.
- Independent technical safety report within the definitions of EN 50129 exists.



protection system



operating temperature



PRODUCT		PMF 2015-M
DATA		
Rated voltage		24 V DC
Operating range		18–30 V
Current consumption	flashing light	0.65 A
	monitoring unit	0.05 A
Alarm contact	contact version	positively driven contact (1 x NC, 1 x NO)
	switching current	max. 6 A
	switching voltage	max. 250 V AC
	max. switching power (AC)	1,500 VA
	recommended min. load	>50 mW
Operating mode		double flash
Light source		xenon flash tube
Flash rate of the main flash		1 Hz = 60 flashes/min
Flash energy of the main flash		7 J
Light intensity (DIN 5037) ¹		250 cd
Max. viewing distance		366 m
Beam angle		vertical approx. 16 °, horizontal 360 °
Operating temperature		–30 °C ... +55 °C
Storage temperature		–40 °C ... +70 °C
Relative humidity		90 %
Protection system (EN 60529)		IP 55 (vertical mounting)
Duty cycle		100 %
Service life of the light source		light emission still 70 % after 8,000,000 flashes
Material	lens	 polycarbonate (PC), fresnel characteristic
	housing	bracket mounting: polycarbonate (PC) / direct mounting: acrylonitrile butadiene styrene (ABS)
Cable entry	bracket mounting	M20x 1.5 for cables 6.5–13.5 mm
Connecting terminal		0.08–2.5 mm ²

¹ with a clear lens

DIMENSIONS

bracket mounting

direct mounting

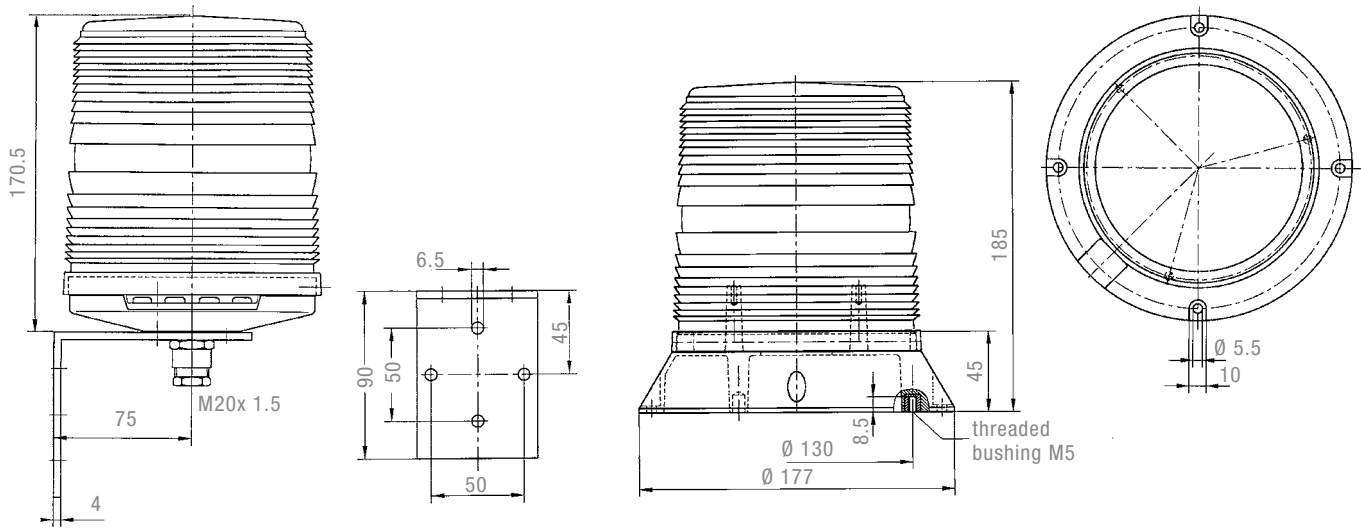

Drilling template 1 for M5 threaded bushing

Drilling template 2

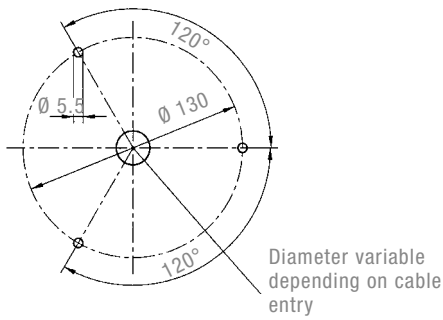

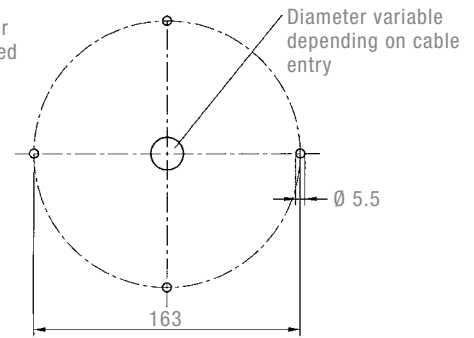

Two different drilling templates are available for fixing the light (direct mounting). M5x 8 threaded bushes are set into the base of the light for fixing according to drilling template 1. Drilling template 2 allows the light to be fixed using 4 through bolts or similar from above.

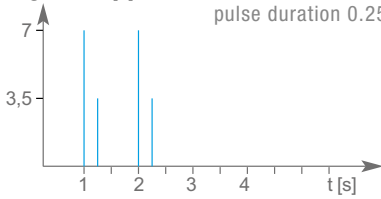

FLASH RATE

Energy single flash [J] 2 flashes
120 flashes/min
pulse duration 0.25 s



ARTICLE NO.	PMF 2015-M bracket mounting
LENS COLOUR	24 V DC
	21007804012
	21007805012

Article numbers for other colours on request.

CONNECTION DIAGRAM

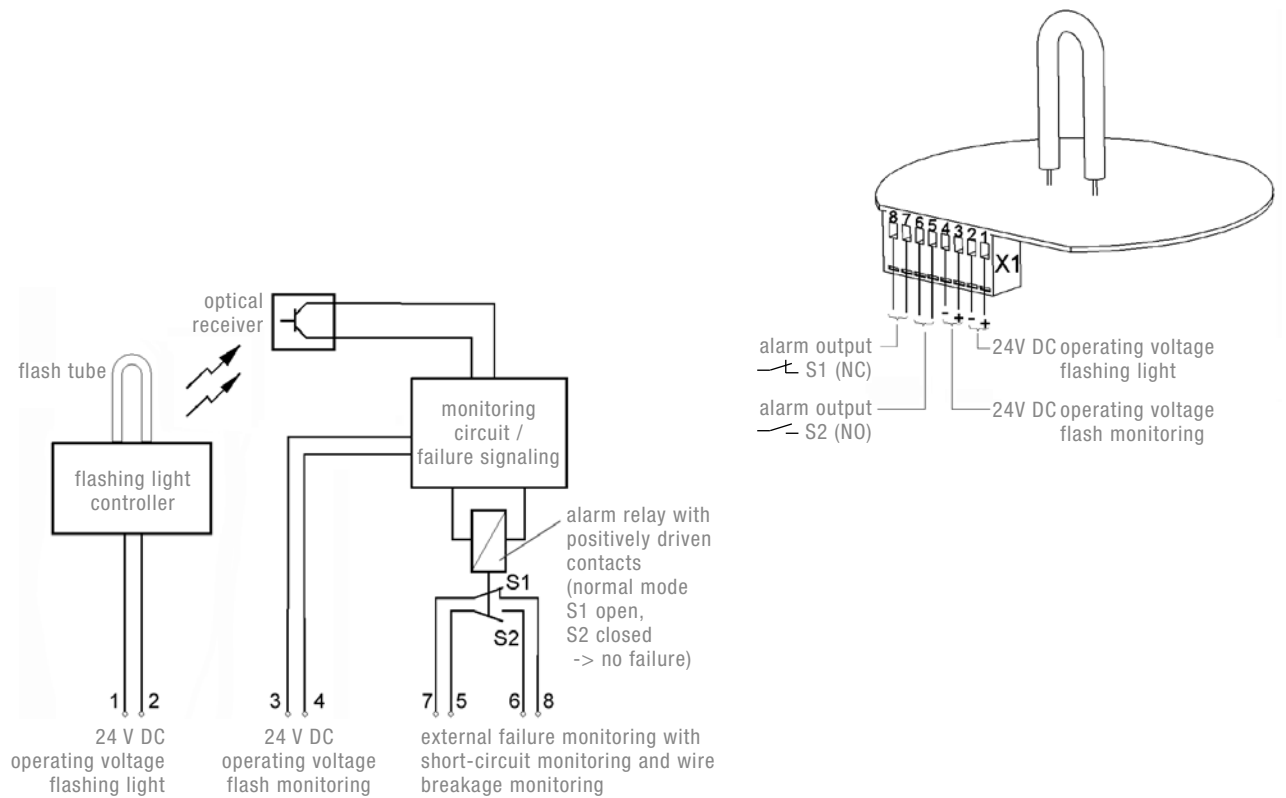

CONFORMITY TO STANDARDS

The visual characteristics of flashing lights conform to the European standard DIN EN 842; “**Machine safety – visual alarm signals**”. Requirements contained in the DIN EN 981 standard; “**Machine safety – system of acoustic and visual alarm and information signals**”, can be fulfilled. The colours “red” for the emergency signal and “yellow” for the warning signal conform to the requirements of IEC 73 / DIN EN 60073 / VDE 0199; “**Coding of display devices and control elements using colours and supplementary means**”.

References to visual alarm devices can be found in the following standards:

- EN 60825-1 Radiation safety of laser devices, identical to IEC 825 and DIN-VDE 0837
- DIN EN 54 Fire alarm systems
- DIN 54113-2 Radiation protection regulations for the technical operation of X-ray equipment up to 500 kV
- EN 50129:2003 Railway applications – telecommunication technology, signalling technology and data processing systems – safety-relevant electronic systems for signal technology
- EN 12352:2000 Traffic routing systems, warning and safety lights class: L1 C red F3 O3 M0 T1 S3