

# H1

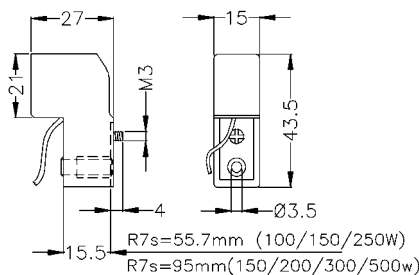

R7s	90/250°C	ACCESSORI ACCESSORIES
10A 250V	IP00	
300°C	APPROVAZIONI APPROVALS	CE c UL US 03



Corpo STEATITE, contatto Cu/Ag, fissaggio con vite M3 inclusa, lunghezza e tipo cavo su richiesta.

*Housing STEATITE, Cu/Ag contact, screw fixing M3 included, alternative wire quality and length on special request.*

# H11



R7s	90/250°C	
10A 250V	IP00	
300°C	APPROVAZIONI APPROVALS	CE c UL US 03

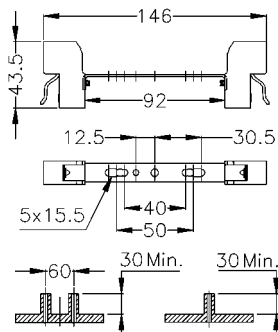

Corpo STEATITE, montato con staffa in metallo zincato, contatto Cu/Ag, fissaggio con viti, lunghezza e tipo cavo su richiesta.

*Housing STEATITE, assembled with zinc-plated bracket, Cu/Ag contact, screw fixing, alternative wire quality and length on special request.*